

Unicell 14LT



The **Unicell 14 LT** is a lightweight version of the standard Unicell module. Like the original, the LT series provides a small, low wind load, low visual impact method to conceal basestation antennas. By removing the provisions for stacking and removing the requirement that the module support the additional wind load of a flag, Jaybeam Wireless was able to reduce the module weight by almost **50%** ! Unicell 14 LT is a perfect solution where co-location is not required or where a flagpole concealment is not necessary.

ADVANTAGES:

- **Reduced Weight**
- **Lower Cost Solution**

FEATURES:

- 3-Sectors inside cylindrical enclosure
- Accommodates standard Jaybeam Wireless cross-polarized antennas
- $\pm 30^\circ$ independent azimuth adjustment per sector
- Removable radome tube for field access

Mechanical Specifications	
Unicell Model No.:	UNX14-14LT
Diameter of Radome:	14.5 in (368 mm)
Height:	72 in (1829 mm)
Weight (excluding antennas):	56 lbs (25.4 kg)
Antennas Accommodated:	See individual antenna datasheet for Unicell Compatibility
Azimuth Swivel for antenna width < 7 in (177 mm):	$\pm 30^\circ$
Azimuth Swivel for antenna width > 7 in (177 mm):	No
Mechanical Tilt:	No
Stackable:	No
Windload @ 100mph (160km/h):	82 lbs (363 N)
Survival Wind:	150 mph (241 km/h)

Electrical Specifications	
Gain Loss through Radome:	<0.4 dB
VSWR:	<1.4:1 Max
Port to Port Isolation:	>28 dB
Sector to Sector Isolation:	>45 dB
Front to Back Ratio:	>25 dB

Refer to individual antenna datasheet for all other Electrical Specifications.

Mounting Options and Accessories	
UNX14-M-120	Mounting Mast x 10 ft (3048 mm)
UNX14-P-xxxx ¹	Mounting Plate
UNX14-W-xxxx ²	Adapter Weldment
UNX14-C	Cable Access Canister
UNX-LPK	Lightning Protection Kit

xxxx¹ = Mounting Plate dia. in inches (i.e.: 14.75" in dia. is UNX14-P-1475)

xxxx² = Adapter Weldment dia. in inches (i.e.: 14.75" in dia. is UNX14-W-1475)

UNICELL FLANGE INTERFACE:

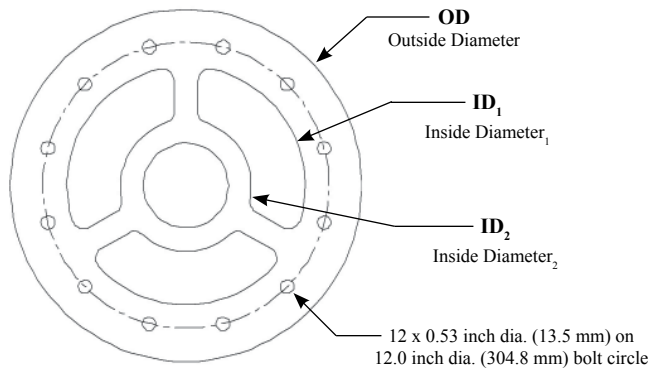

OD: 14.75 inches (368.3 mm)
ID₁: 10.00 inches (254 mm)
ID₂: 5.50 inches (139.7 mm)