

## UNX14-xx

### 14-inch diameter Antenna Enclosure

- 3-Sectors inside cylindrical enclosure
- Accommodates standard Amphenol Antenna Solutions cross-polarized antennas
- Independent azimuth adjustment per sector
- Stackable to satisfy co-location requirements
- Removable radome segments for easy field access

Mechanical Specifications				
Unicell Model Number (xx)	UNX14-14		UNX14-19	
Diameter of radome	368 mm	14.5 in	368 mm	14.5 in
Height	1829 mm	72 in	2438 mm	96 in
Weight (excluding antennas)	51.8 kg	114 lbs	60.9 kg	134 lbs
Antennas accommodated	See Unicell and Antenna Compatibility table or individual antenna datasheet.			
Azimuth swivel for antenna width < 7 in (177 mm)	Yes*		Yes*	
Azimuth swivel for antenna width > 7 in (177 mm)	No		No	
Mechanical tilt:	No		No	
Stackable	Yes		Yes	
Windload @ 100mph (160km/h)	363 N	82 lbf	484 N	109 lbf
Survival wind - single model	241 km/h	150 mph	241 km/h	150 mph
Survival wind - stacked models	241 km/h	150 mph	185 km/h	115 mph

\*Azimuth swivel will depend on antenna model used. See Unicell and Antenna Compatibility table for available features.

Electrical Characteristics	
Gain loss through radome	< 0.3 dB
VSWR	< 1.4:1 Max
Port to port isolation	> 28 dB
Sector to sector isolation	> 45 dB
Front to back ratio	> 25 dB

Refer to individual antenna datasheets for all other electrical specifications.

Mounting Options	Part Number	Description
Mounting mast	UNX14-M-120	Mounting mast, 120 in x 14 in dia
Flag adapter kit	UNX14-F	14 in Unicell ball and truck assembly
Cable access canister	UNX14-C	14 in Unicell Canister
Lightning protection kit	UNX-LPK	Copper air finial with 6m (20 ft) cable attached

#### Unicell Flange Interface:

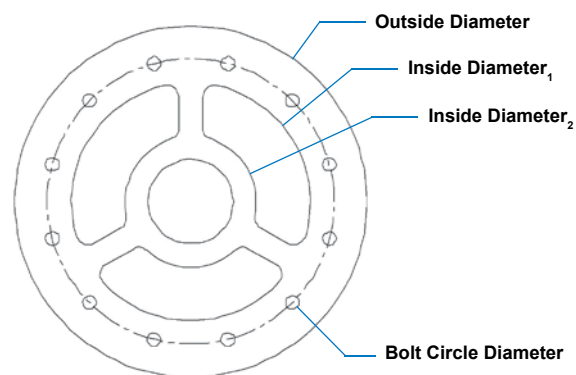

OD:	14.75 inches (374.7 mm)
ID <sub>1</sub> :	10.00 inches (254 mm)
ID <sub>2</sub> :	5.50 inches (139.7 mm)
BCD:	12 x 0.53 inch dia. (13.5 mm) on 12.0 inch dia. (304.8 mm) bolt circle

